

Posición	Descripción	Referencia
1	Set 2 enchufes <i>2 Plugs set</i>	ER3100/01
2	Set 2 espejos y 2 faroles <i>2 rearviews and two lamps set</i>	ER3100/02
3	Set 20 argollas <i>20 rings set</i>	ER3100/03
4	Set 2 limpiaparabrisas <i>2 windscreenwipers set</i>	ER3100/04
5	Set 2 bocinas <i>2 Horns set</i>	ER3100/05
6	Set asideros frontales <i>Front hand holds set</i>	ER3100/06
7	Set asideros puerta cabina <i>Cabin door hand holds set</i>	ER3100/07
8	Set asideros puerta central <i>Central door hand holds set</i>	ER3100/08
9	Rejilla ventilador <i>Fangrill</i>	ER3100/09
10	Rejilla techo <i>Roof grill</i>	ER3100/10
11	Carrocería <i>Bodyshell</i>	ER3113/11
12	Set difusores (superior) <i>Upper diffusers set</i>	ER3100/12
13	Set cristales <i>Glasses set</i>	ER3113/13
14	Set iluminación frontal <i>Front lighting set</i>	ER3100/14
15	Set cabina <i>Cab set</i>	ER3100/15
16	Maquinista <i>Driver</i>	ER34074
17	Set difusores (inferior) <i>Lower diffusers set</i>	ER3100/17
18	Set 4 topes <i>4 buffers set</i>	ER3100/18
19	Set ganchos y mangueras <i>Hooks and hoses set</i>	ER3100/19
20	Faldón decorativo <i>Decorative snow plough</i>	ER3100/20
21	Faldón funcional <i>Functional snow plough</i>	ER3100/21

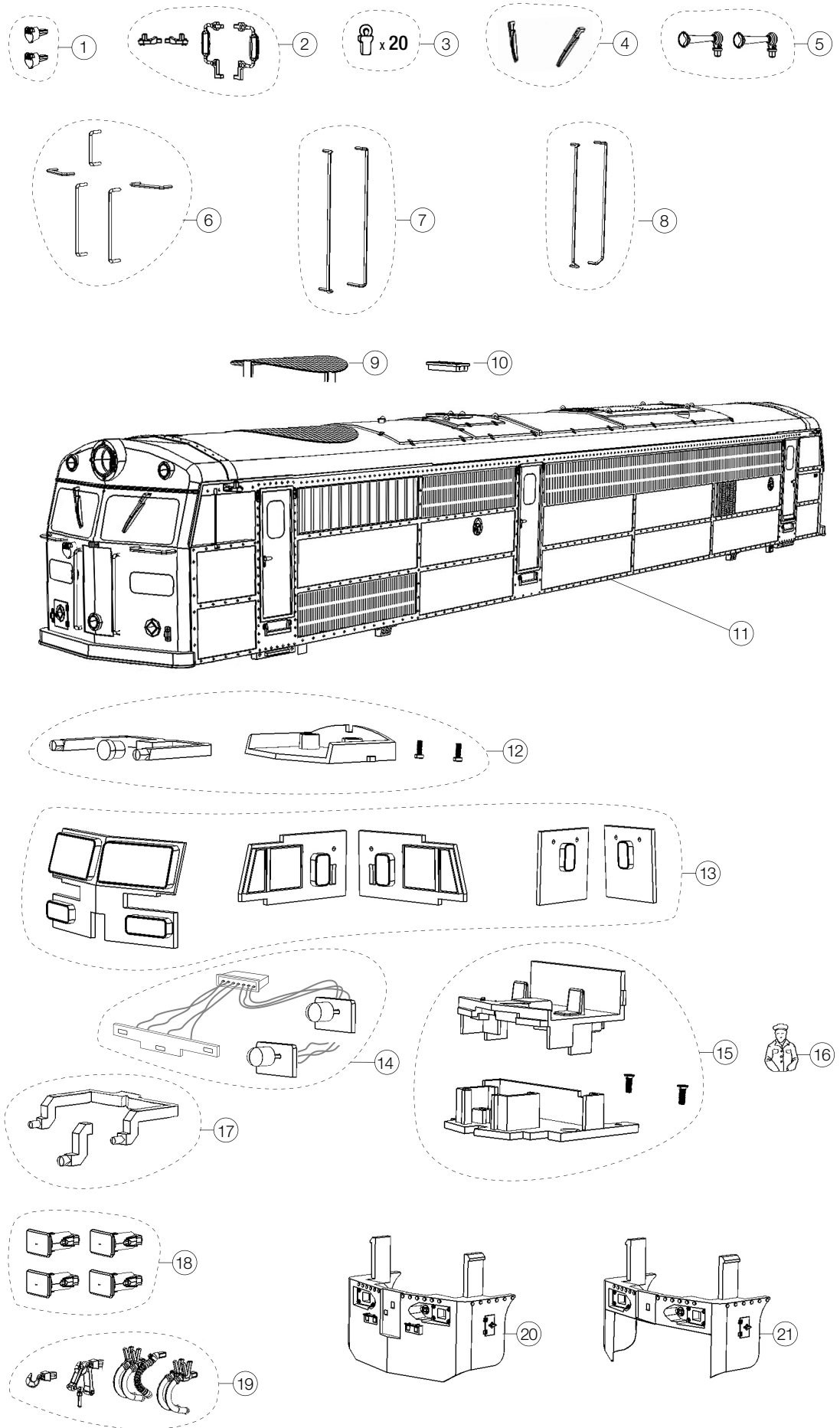

Posición	Descripción	Referencia
22	Circuito impreso <i>Printed circuit</i>	ER3100/22
23	Set ventilador con motor <i>Fan with engine set</i>	ER3100/23
24	Set contactos movimiento ventilador (x4) <i>Fan contact set (4x)</i>	ER3100/24
25	Set motor principal <i>Main motor set</i>	ER3100/25
26	Caja decoder <i>Decoder box</i>	ER3100/26
27	Set cojinete <i>Bush set</i>	ER3100/27
28	Set sinfín <i>Worm-gear set</i>	ER3100/28
29	Cardán <i>cardan</i>	ER3100/29
30	Soporte enganche K + muelle <i>K-Coupling holder + spring</i>	ER3100/30
31	Bloque bastidor <i>Frame</i>	ER3100/31
32	Set Enganche <i>Coupling set</i>	ER3100/32
33	Set cobertura bogie <i>Bogie cover set</i>	ER3100/33
34	Set cobertura bogie (con tacómetro) <i>Bogie cover set (with tachometer)</i>	ER3100/34
35	Bulón bogie <i>Bogie pin</i>	ER3100/35
36	Tapa sinfín <i>Worm-gear cover</i>	ER3100/36
37	Bogie completo DC <i>DC complete bogie</i>	ER3100/37
38	Bogie completo AC <i>AC complete bogie</i>	ER3100/38
39	Bogie completo AC para patín <i>AC complete bogie for pick-up shoe</i>	ER3100/39
40	Contacto rueda (x4) <i>Wheel current pick-up (4x)</i>	ER3100/40
41	Tornillo + terminal <i>Screw + terminal</i>	ER3100/41
42	Base bogie + Tornillos <i>DC bogie base + screws</i>	ER3100/42
43	Base bogie para patín AC <i>Bogie base for AC pick-up shoe</i>	ER3100/43
44	Ruedas engranaje y aro DC <i>DC Geared wheels with ring</i>	ER3100/44
45	Ruedas engranaje y aro AC <i>AC Geared wheels with ring</i>	ER3100/45
46	Ruedas engranaje sin aro DC <i>DC Geared wheels without ring</i>	ER3100/46
47	Ruedas engranaje sin aro AC <i>AC Geared wheels without ring</i>	ER3100/47
48	Ruedas sin engranaje AC <i>AC Wheels without gear</i>	ER3100/48
49	Set accesorios bogie <i>Accessories set for bogie</i>	ER3100/49
50	Set accesorios para bogie con tacómetro <i>Accessories set for bogie with tachometer</i>	ER3100/50
51	Patín AC <i>AC Pick-up shoe</i>	ER6850A
52	Tornillo patín <i>Pick-up shoe screw</i>	ER6851
53	Set de engranajes <i>Gears set</i>	ER3100/53
54	Engranaje doble <i>Double gear</i>	ER3100/54
55	Caja altavoz <i>Speaker box</i>	ER3100/55
56	Aro de adherencia (x4) <i>Grip ring (4x)</i>	ER3100/56
57	Caja de engranajes <i>Gears box</i>	ER3100/57
58	Eje de engranaje <i>Gear axle</i>	ER3100/58
59	Depósito fuel <i>Fuel tank</i>	ER3100/59
60	Accesorios depósito fuel <i>Fuel tank accessories</i>	ER3100/60
61	Bolsa accesorios <i>Accessories bag</i>	ER3100/61

